

THE TIMBERS

Plan 2674 • 2,674 square feet



ELEVATION A



ELEVATION B



ELEVATION C



TEXAS-HOMES.COM

*These are artist renderings and actual elevation detailing are subject to change.
Refer to Sales Counselor and review actual blueprint. Rev. 03/19/19*



TEXAS HOMES

Texas Built • Texas Owned • Texas Proud

THE TIMBERS

Plan 2674 • 2,674 square feet



ELEVATION D



ELEVATION E



TEXAS-HOMES.COM

*These are artist renderings and actual elevation detailing are subject to change.
Refer to Sales Counselor and review actual blueprint. Rev. 03/19/19*



TEXAS HOMES

Texas Built • Texas Owned • Texas Proud

THE TIMBERS

Plan 2674 • 2,674 square feet

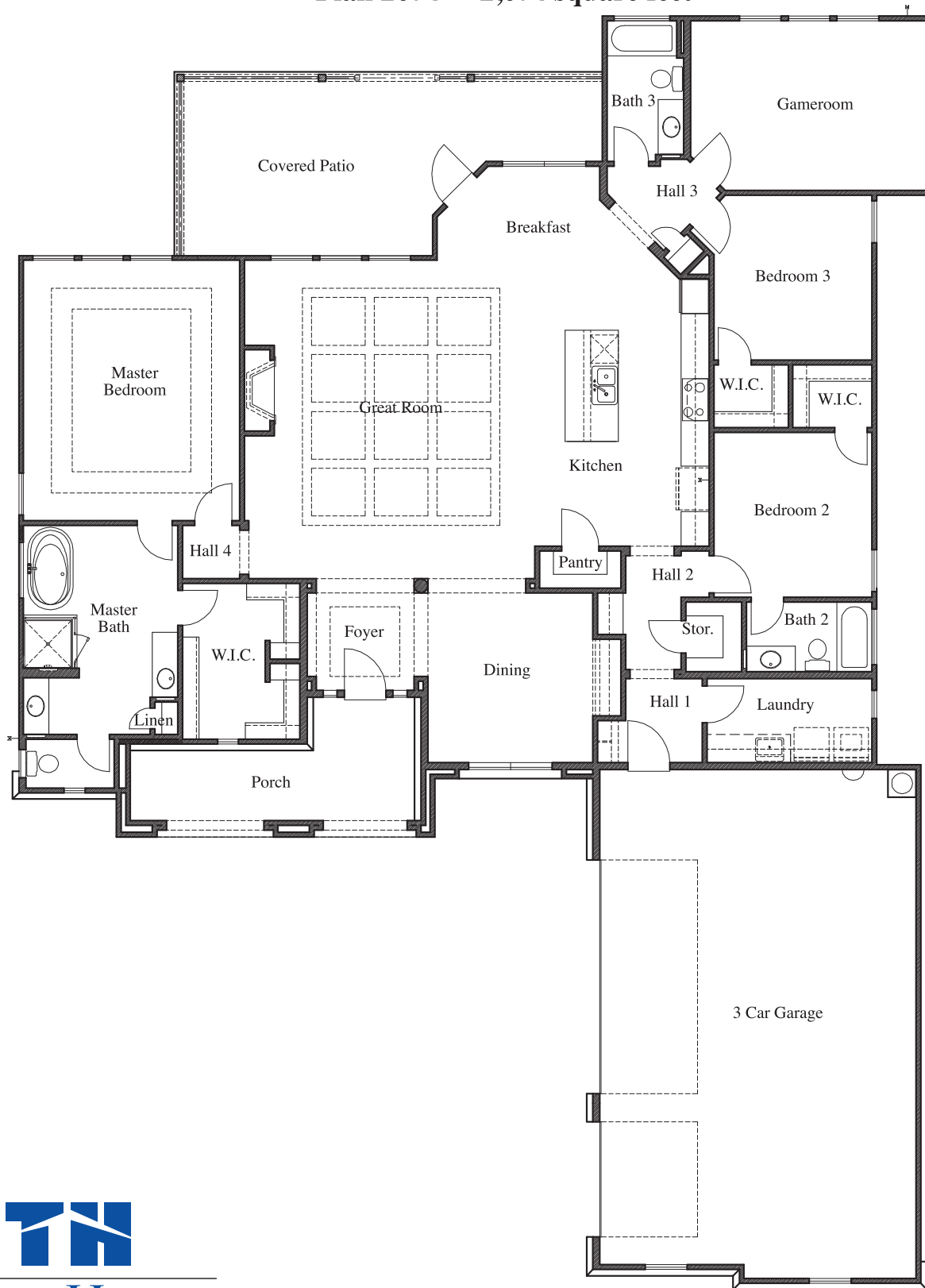

THE TIMBERS

Plan 2674 • Options

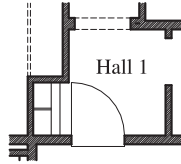

Mudroom Cabinet

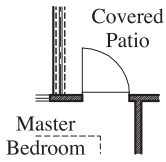

Door at Master Bedroom

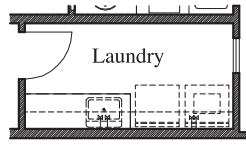

Cabinets at Laundry

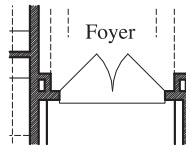

Double Doors at Front Porch

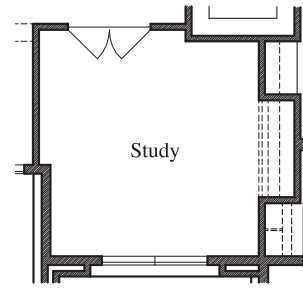

*Study at Dining
Optional Cabinets at Study*

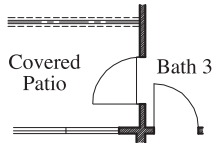

Door at Bath 3

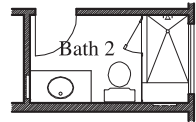

Mudset Shower with Seat & Niche at Bath 2

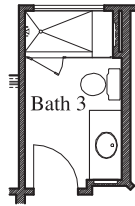

Mudset Shower with Seat & Niche at Bath 3

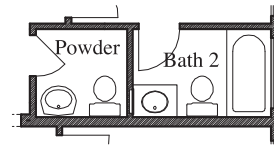

Powder Bath at Storage

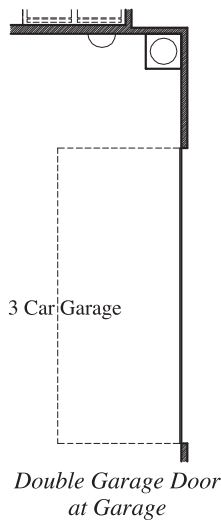

*3 Car Garage
Double Garage Door at Garage*

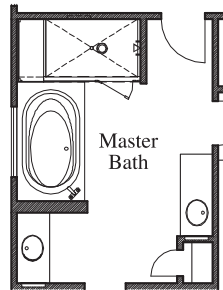

Drop-In Tub with Large Mudset Shower with Seat & Niche at Master Bath

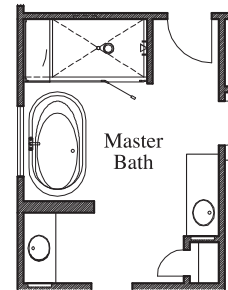

Large Mudset Shower with Seat & Niche at Master Bath

