

THE TIMBERS

Plan 3245 • 3,245 square feet



ELEVATION A



ELEVATION B



ELEVATION C



TEXAS-HOMES.COM

*These are artist renderings and actual elevation detailing are subject to change.
Refer to Sales Counselor and review actual blueprint. Rev. 03/19/19*



TEXAS HOMES

Texas Built • Texas Owned • Texas Proud

THE TIMBERS

Plan 3245 • 3,245 square feet



ELEVATION D



ELEVATION E



TEXAS-HOMES.COM

*These are artist renderings and actual elevation detailing are subject to change.
Refer to Sales Counselor and review actual blueprint. Rev. 03/19/19*



TEXAS HOMES

Texas Built • Texas Owned • Texas Proud

THE TIMBERS

Plan 3245 • 3,245 square feet

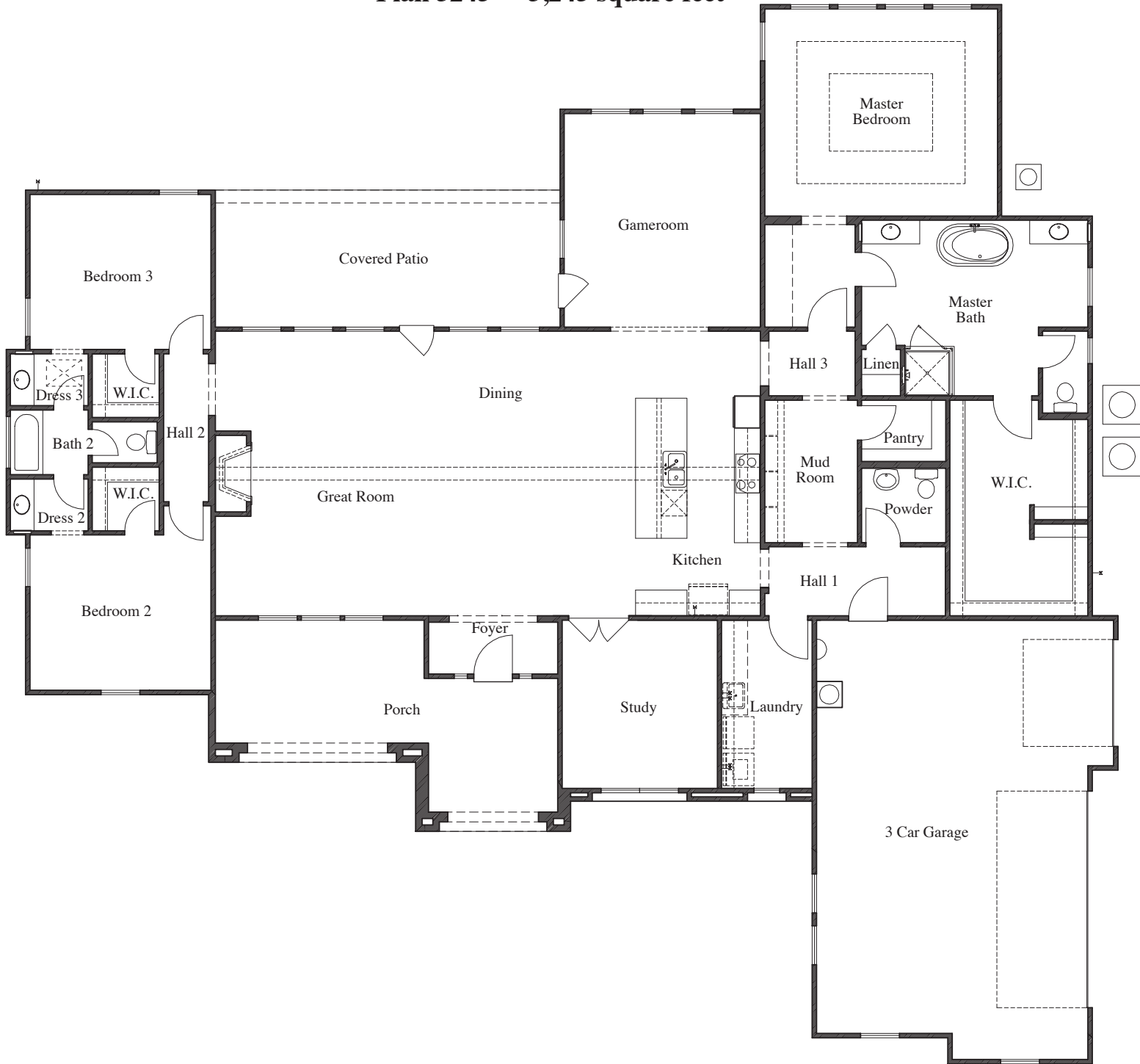

TEXAS-HOMES.COM

Actual room dimensions may vary. See a sales counselor for more information. Rev. 11/04/20



TEXAS HOMES

Texas Built • Texas Owned • Texas Proud

THE TIMBERS

Plan 3245 • Options

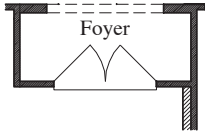

Double Doors at Front Porch



8' Accordion Door at Great Room

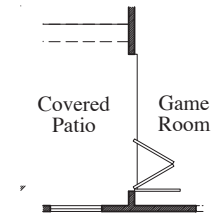

8' Accordion Door at Game Room

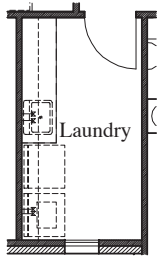

Cabinets at Laundry

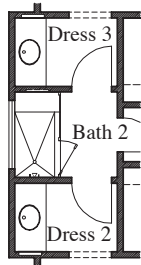

Mudset Shower with Seat & Niche at Bath 2

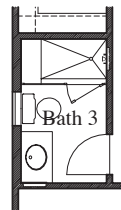

Mudset Shower with Seat & Niche at Bath 3

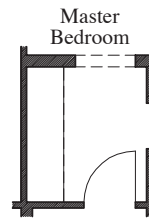

Linen at Master Bedroom

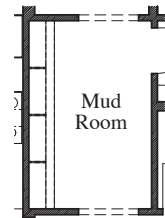

Coat Storage at Mud Room

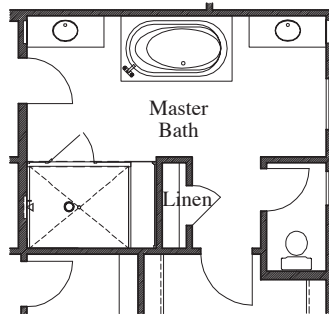

Drop-In Tub with Large Mudset Shower with Seat & Niche at Master Bath

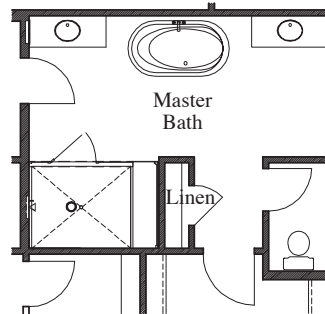

Large Mudset Shower with Seat & Niche at Master Bath

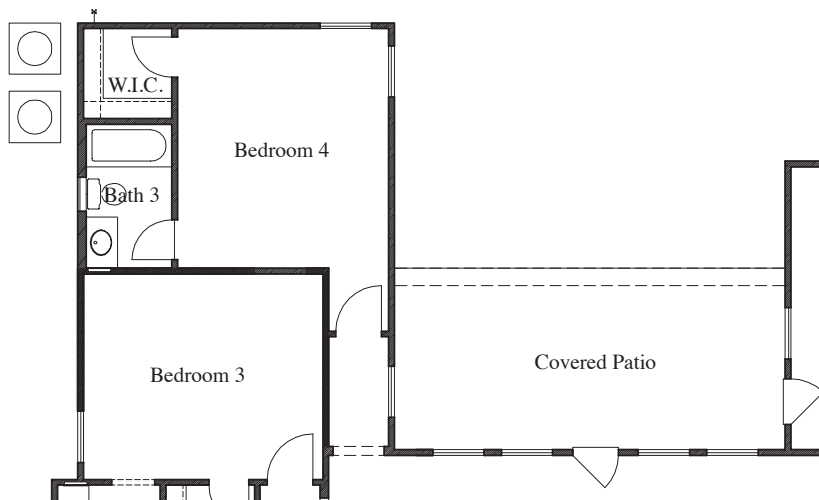

Bedroom 4 with Bath 3

