

THE TIMBERS

Plan 3494 • 3,494 square feet



ELEVATION A



ELEVATION B



ELEVATION C



TEXAS-HOMES.COM

*These are artist renderings and actual elevation detailing are subject to change.
Refer to Sales Counselor and review actual blueprint. Rev. 03/19/19*



TEXAS HOMES

Texas Built • Texas Owned • Texas Proud

THE TIMBERS

Plan 3494 • 3,494 square feet



ELEVATION D



ELEVATION E



TEXAS-HOMES.COM

*These are artist renderings and actual elevation detailing are subject to change.
Refer to Sales Counselor and review actual blueprint. Rev. 03/19/19*



TEXAS HOMES

Texas Built • Texas Owned • Texas Proud

THE TIMBERS

Plan 3494 • 3,494 square feet

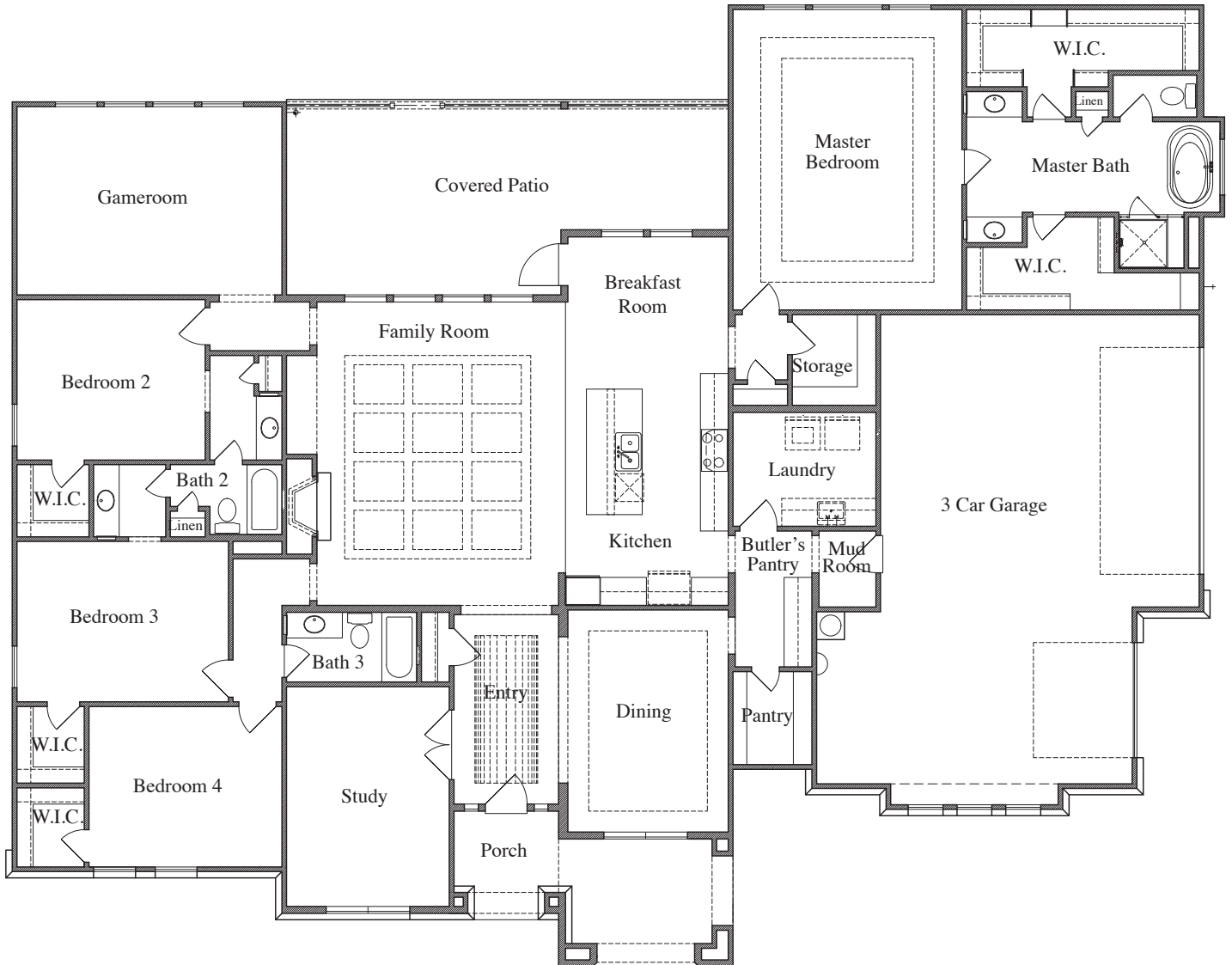

THE TIMBERS

Plan 3494 • Options

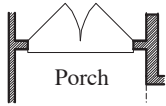

*Double Doors
at Front Porch*

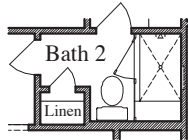

*Mudset Shower with
Seat & Niche at Bath 2*

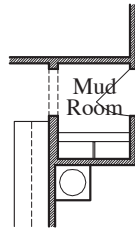

*Cabinet at
Mud Room*

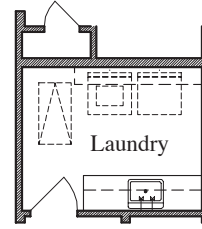

*Sink & Cabinets
at Laundry*

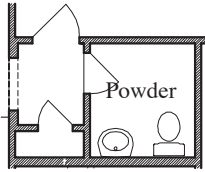

*Powder at
Storage*

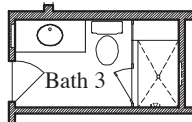

*Mudset Shower with
Seat & Niche at Bath 3*

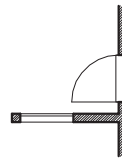

*Door at Master
Bedroom*

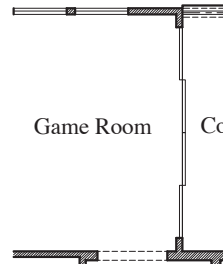

*Sliding Door
at Game Room*

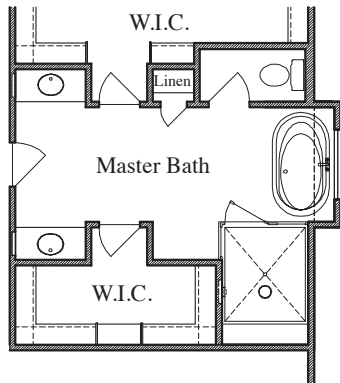

*Large Mudset Shower with
Seat & Niche at Master Bath*

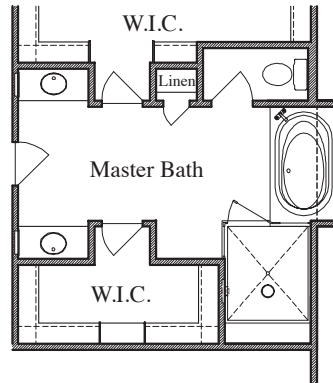

*Drop-In Tub with Large Mudset Shower
with Seat & Niche at Master Bath*

